

# This furniture contains the Timberline File Frame System

which is easily adjusted  
to meet your filing needs.

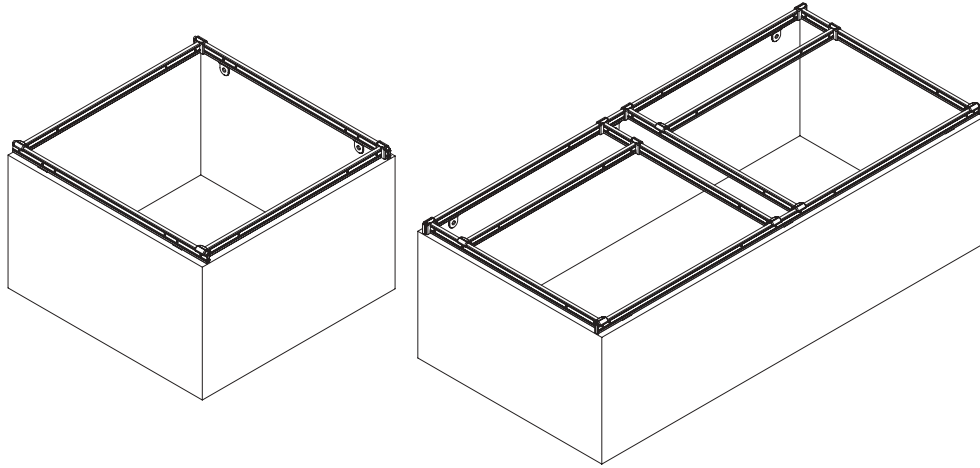

Depending on your drawer size, the following file configurations may be possible:

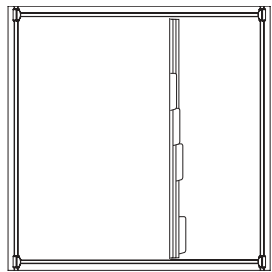

side to side legal

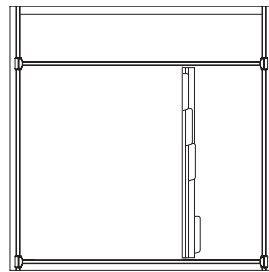

side to side letter

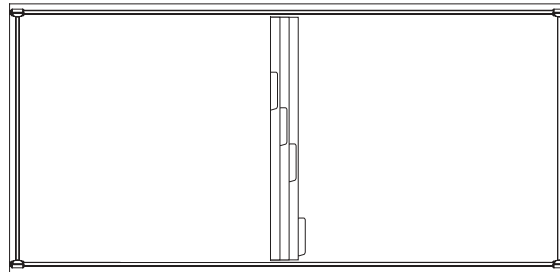

side to side legal

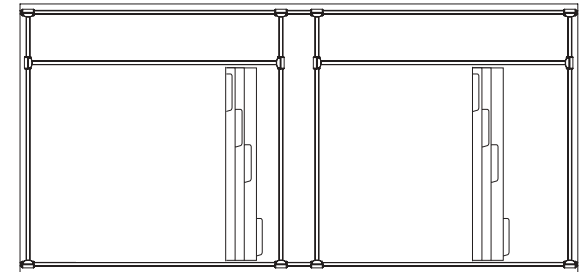

side to side letter

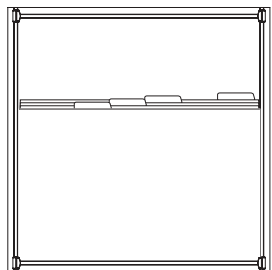

front to back legal

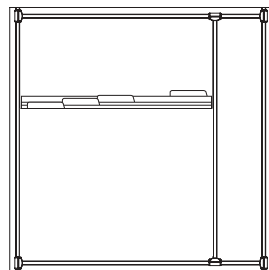

front to back letter

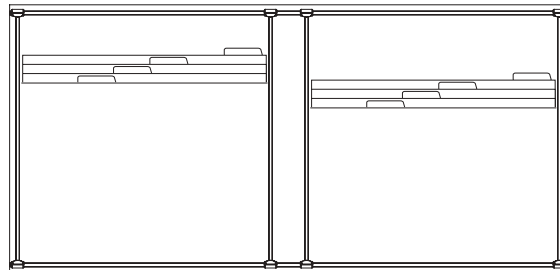

front to back legal

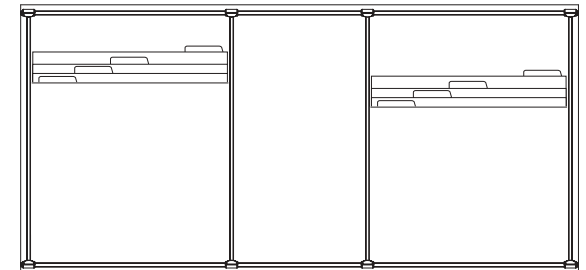

front to back letter

*To configure your drawer, see the instructions on the back side of this sheet.*

## To configure your drawer:

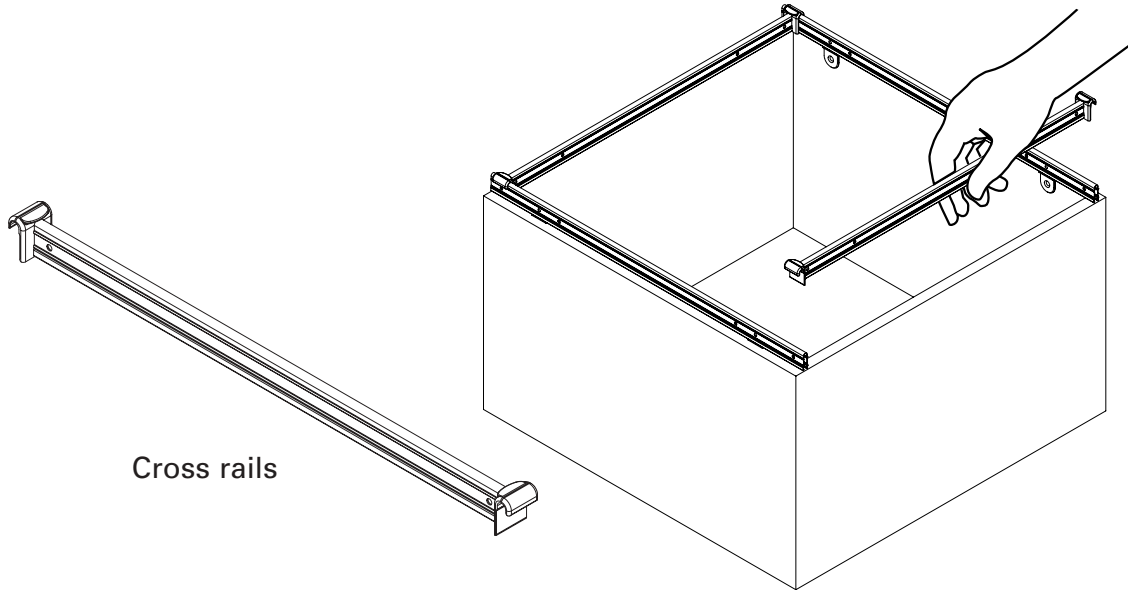

Cross rails can be moved between various positions.

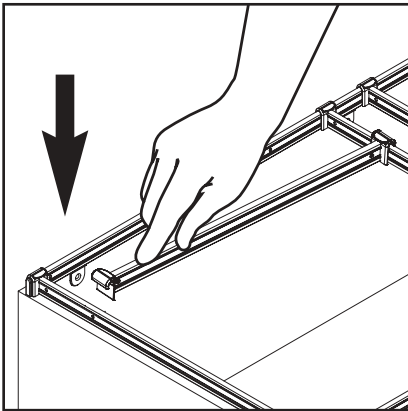

**To install cross rails,** push down as shown.

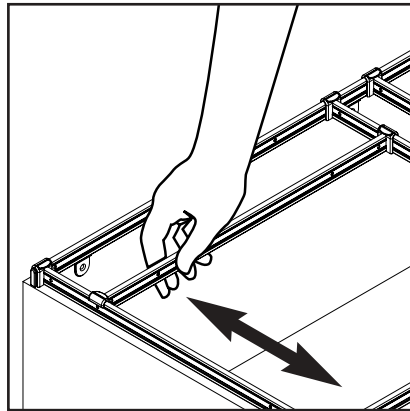

Slide back and forth until rail locks into place.

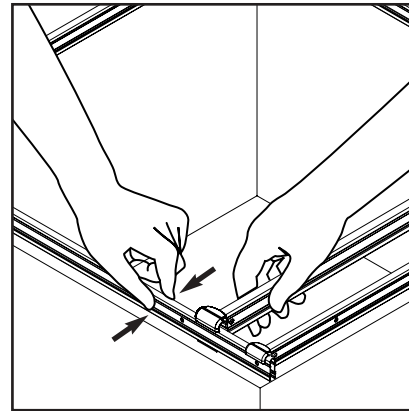

**To remove cross rails,** squeeze profile as shown.

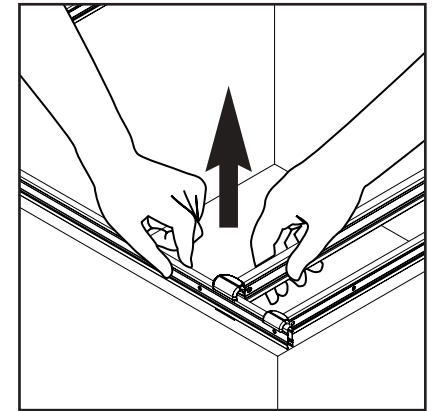

While squeezing profile, lift cross rail straight up.